

IS HEADTUBE

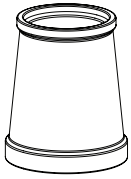

Industry Nine products are designed to keep you in the saddle and out of the service queue. Regular service and maintenance is simple and can be performed with basic tools readily available to the home or shop mechanic - *no proprietary tools are required.*

To properly service your Industry Nine iRiX Headset, please follow the steps below.

For more information: Call 828-210-5113, email service@industry9.com or visit industry9.com/support

5MM TOP COVER ASSEMBLY

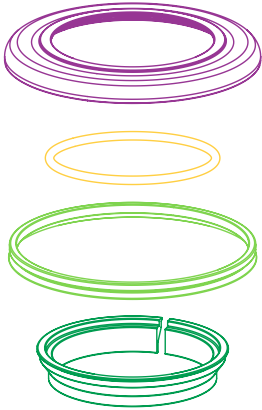

15MM TOP COVER ASSEMBLY

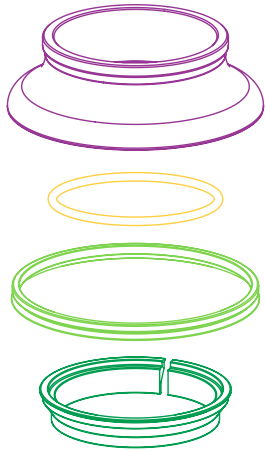

SHIMS



BOLT | TOP CAP | STAR NUT

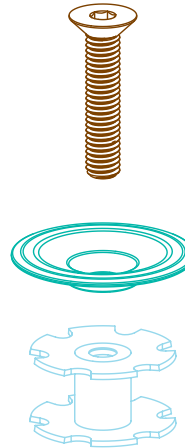

BEARINGS | SEAL | CROWN RACE

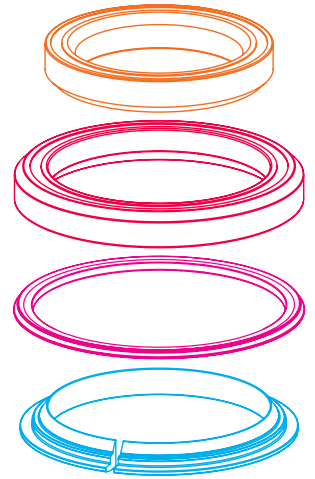

1

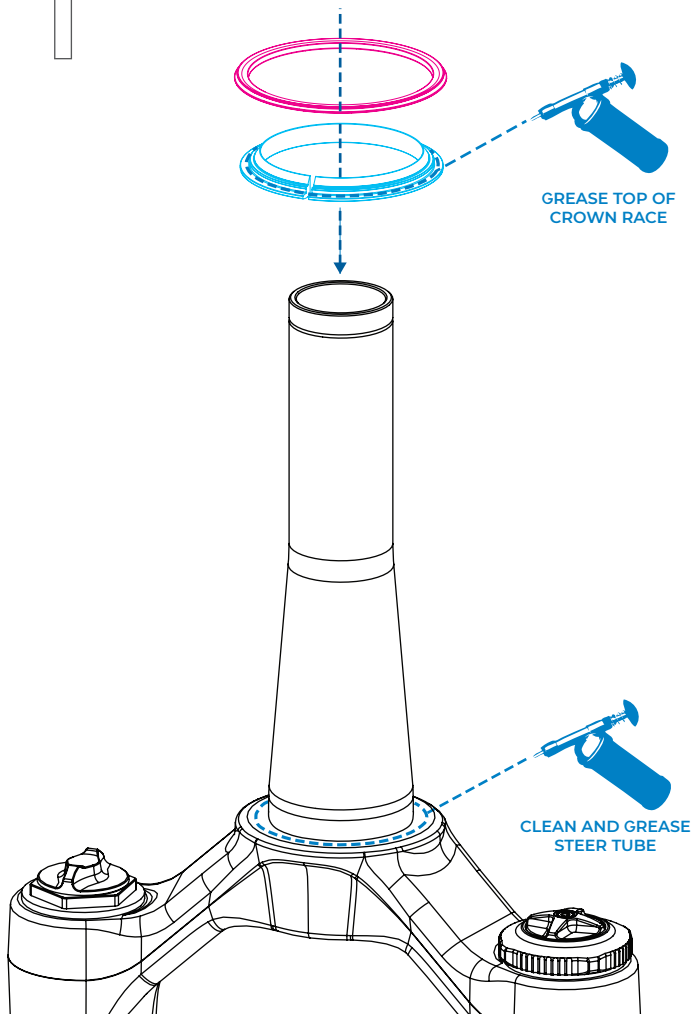

2

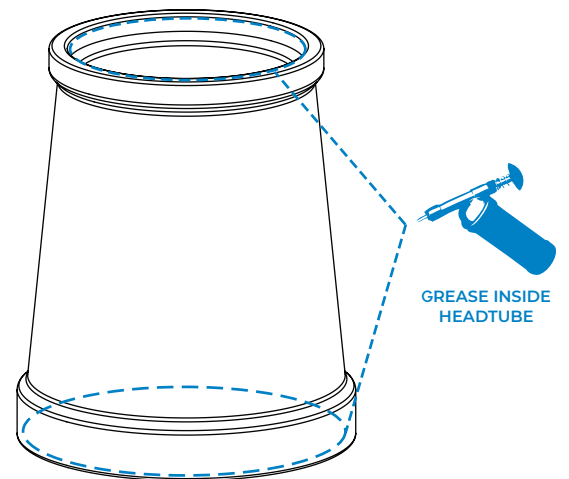

3

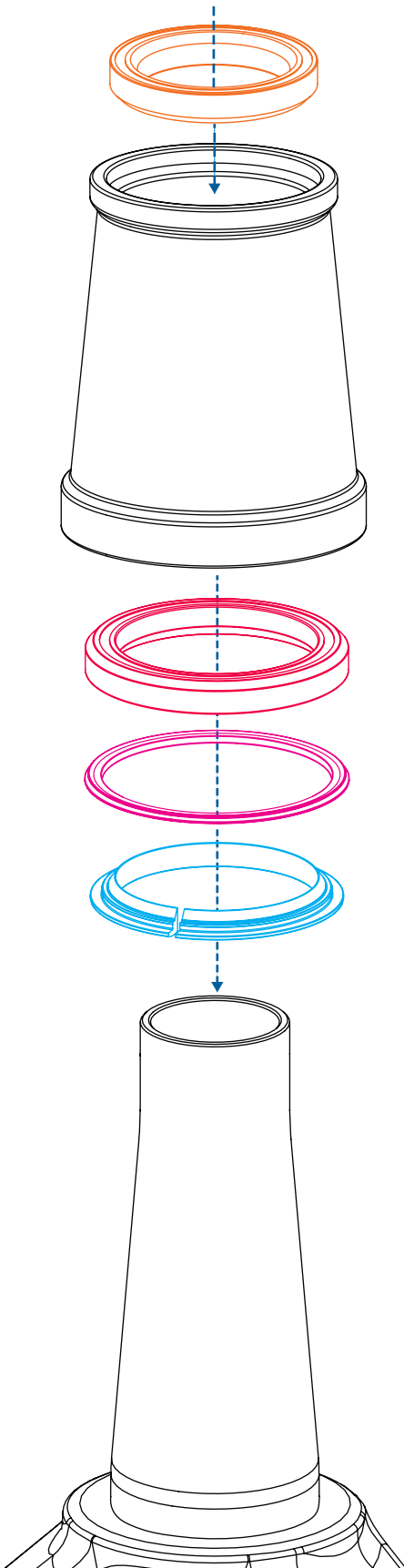

4

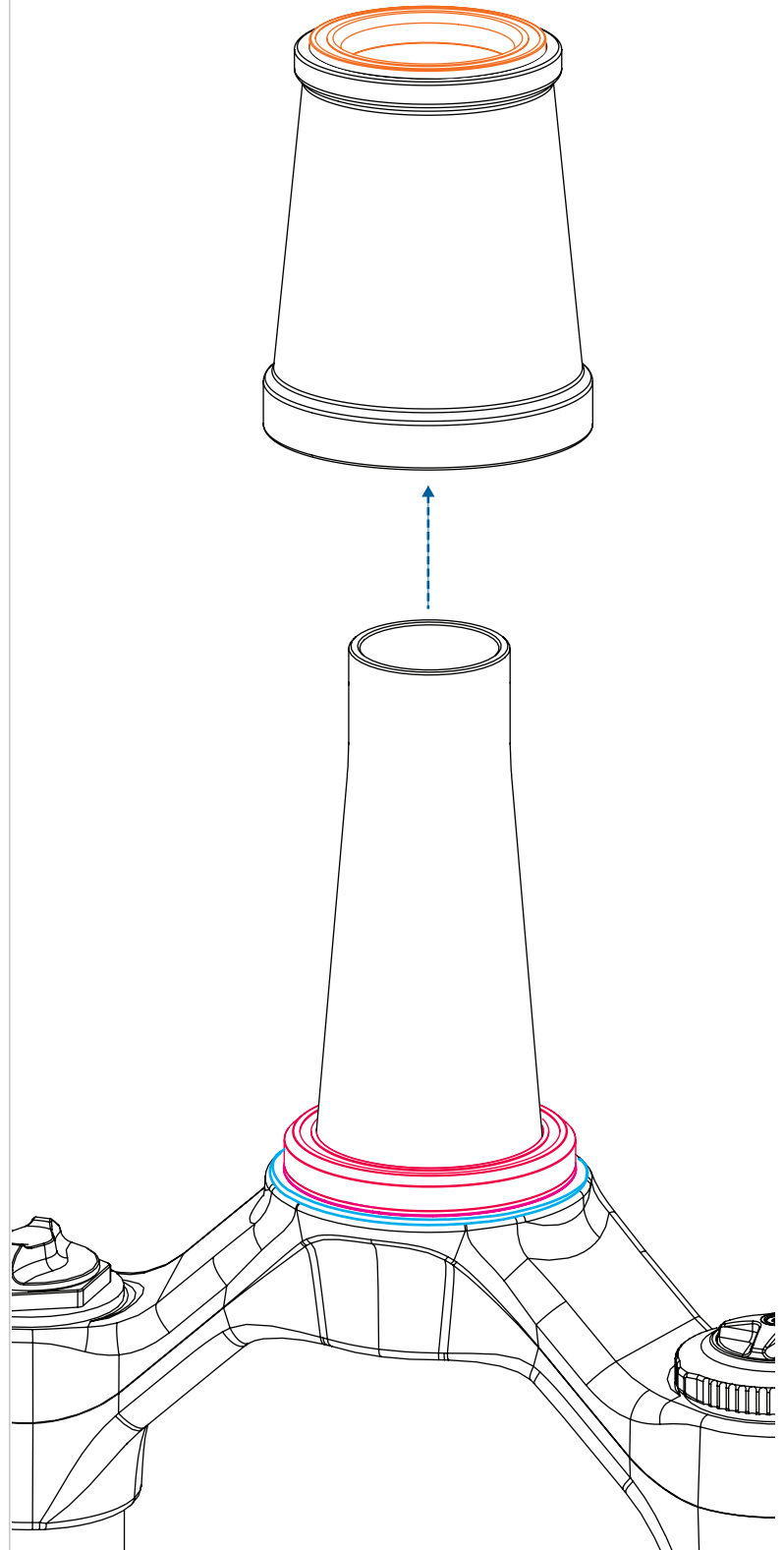

5

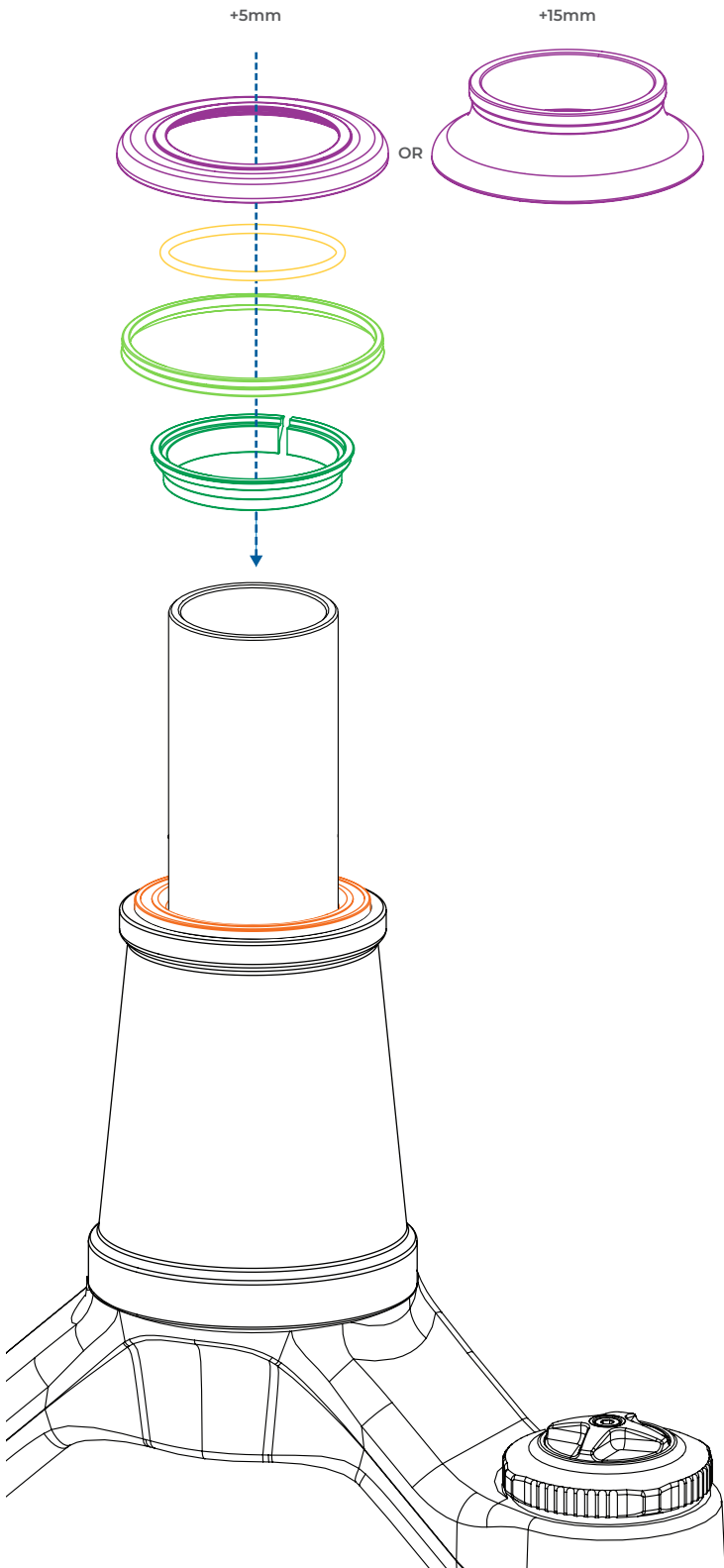

6

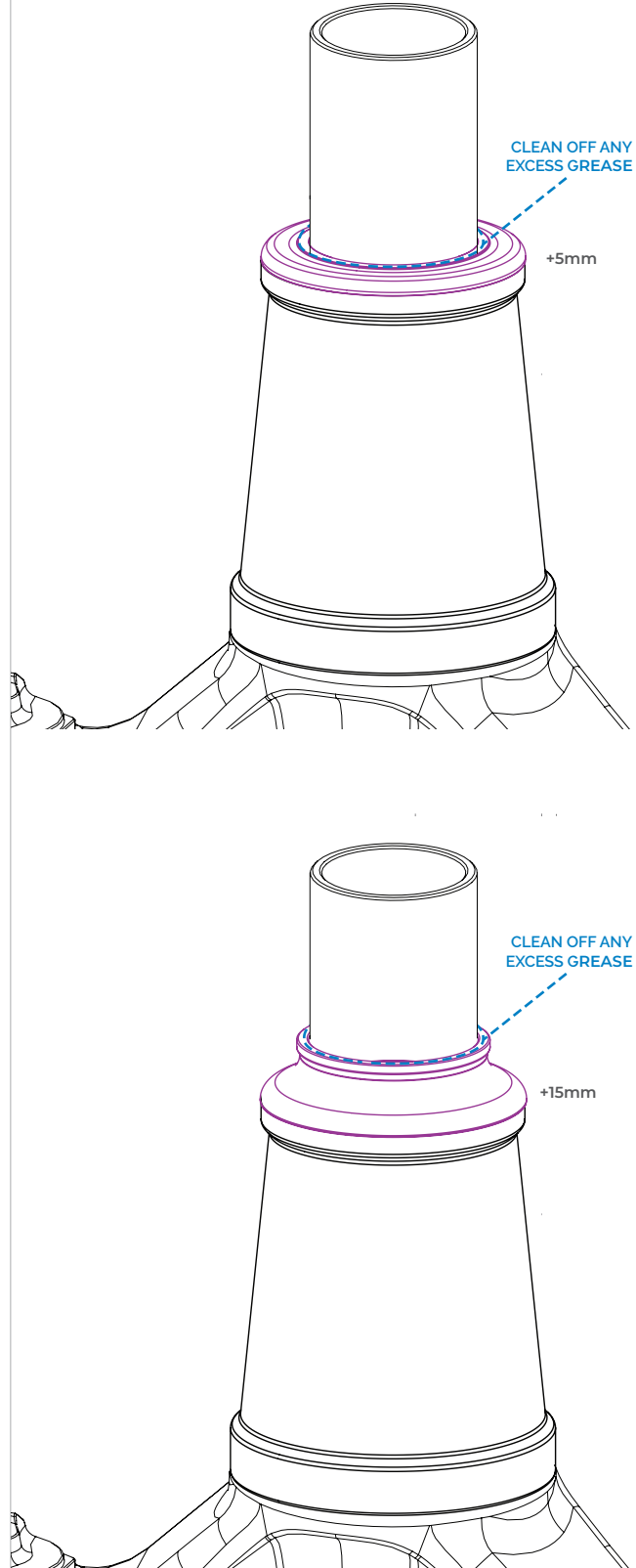

7



5mm SPACER
(sold separately)

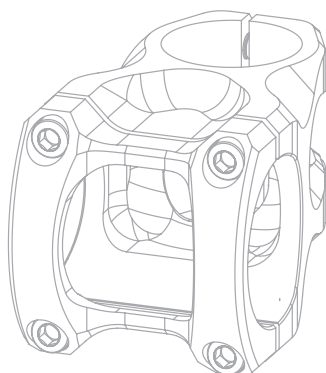
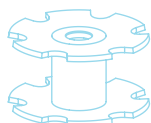

STEM
(sold separately)



20mm SPACER
(sold separately)

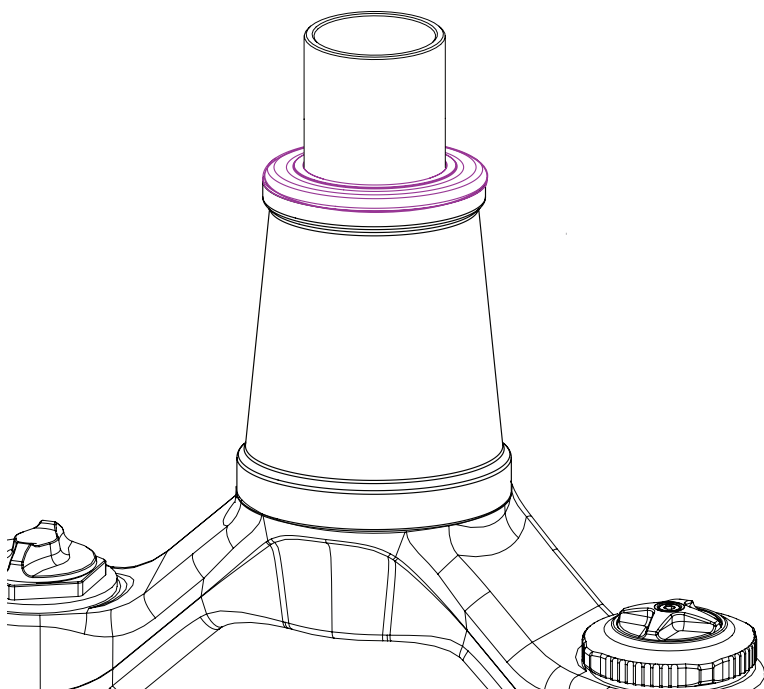

8



PRE-LOAD HEADSET
(Tighten until all play is removed)

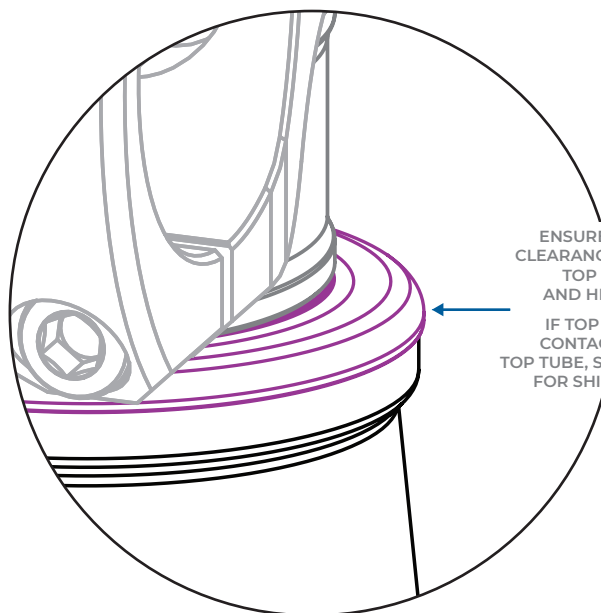
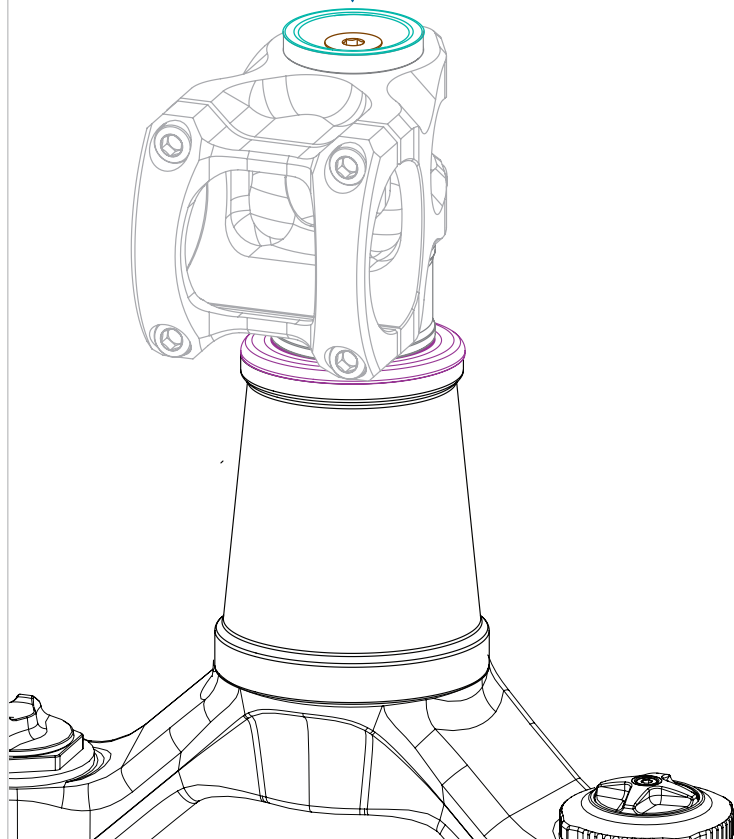

ENSURE PROPER
CLEARANCE BETWEEN
TOP COVER
AND HEADTUBE.
IF TOP COVER IS
CONTACTING THE
TOP TUBE, SEE NEXT PAGE
FOR SHIM INSTALL.

SHIM INSTALL

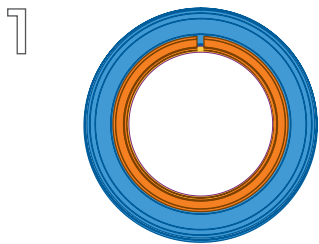
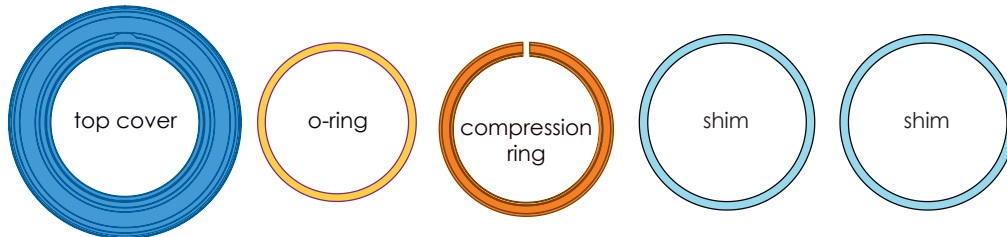

REMOVE COMPRESSION RING FROM THE BACKSIDE OF TOP COVER.

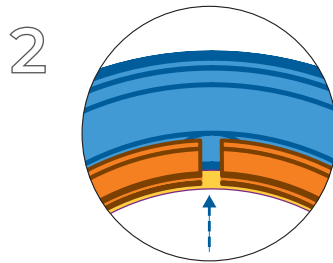

GENTLY WALK COMPRESSION RING OUT OF TOP COVER GROOVE.

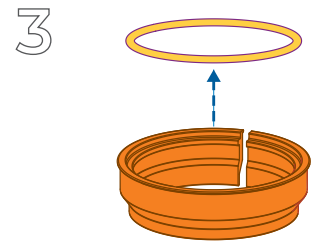

UPON REMOVAL, BE MINDFUL OF THE O-RING THAT IS NESTED IN THE COMPRESSION RING.

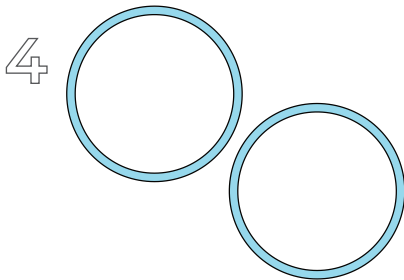

INSTALL SHIMS AS NEEDED TO ENSURE HEAD TUBE CLEARANCE.

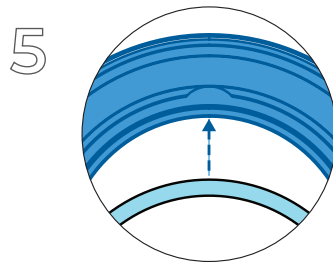

TO INSTALL SHIM, USE KEYWAY TO WALK SHIM INTO THE GROOVE ON BACKSIDE OF TOP COVER.

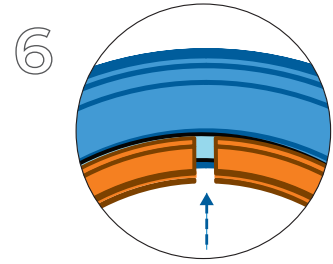

REPLACE COMPRESSION RING BY GENTLY WALKING INTO TOP COVER GROOVE.

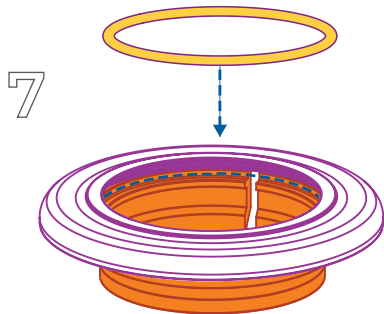

REPLACE O-RING INTO GROOVE BETWEEN TOP COVER AND COMPRESSION RING.

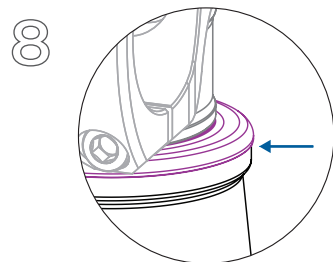

INSTALL SPACERS, STEM AND TOP CAP. CHECK FOR PROPER CLEARANCE BETWEEN TOP COVER AND TOP TUBE.

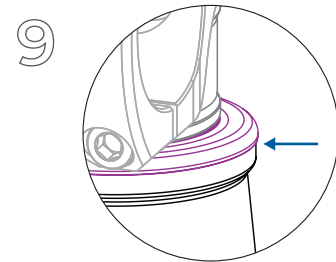

IF MORE CLEARANCE IS NEEDED ADD A SECOND SHIM TO BACKSIDE OF TOP COVER.